

Cleaning:

- > Disconnect the power and clean the exterior only of this fitting with a soft dry cloth.
- > Do not use any chemical or abrasive cleaners.

Specification:

Voltage: 240V ~/ 50Hz
Maximum power output: 2400W
Switch positions: 800W, 1600W or 2400W.
Thermostat: Graduated 0 through 6 to MAX.

Eventually, you may want to replace this light fitting:

When your light fitting comes to the end of its life or you choose to update or upgrade it by replacing it, please do not dispose of it with your normal household waste, please recycle where facilities exist. When you need to dispose of this fitting, check with your retailer or local authority for suitable options. New regulations require the recycling of Waste from Electrical and Electronic Equipment (European "WEEE Directive" effective August 2005—UK WEEE Regulations effective 2nd January 2007).

Environment Agency Registered Producer: WEE/GA0248QZ



If you experience problems:

If your heater is defective or develops a fault, please return it to the place where you bought it. You can call our Helpline for advice. The Helpline will gladly give advice on any aspect of any Eterna product but may not be able to give specific instructions regarding individual installations.

If in doubt, consult a qualified electrician.

Help line:

Tel: 01933 673 144 Fax: 01933 678 083 Email: sales@eterna-lighting.co.uk
For answers to frequently asked questions (FAQs) and other information visit our web-site
www.eterna-lighting.co.uk



IMPORTANT!

Safety and Installation instructions

Plinth Fan Heater

Model(s)
PFH2400

Pack contents:

Plinth Heater (Brown fascia panel)	1
White Fascia Panel	1
Brushed Nickel Fascia Panel	1
Screw fixing kit (2 colours)	1

**PLEASE READ THESE INSTRUCTIONS BEFORE
INSTALLING YOUR NEW FITTING**

PLEASE RETAIN FOR FUTURE REFERENCE

Read this first:

- > **This heater must be installed in accordance with the Building Regulations.** These may be obtained from HMSO or viewed and downloaded from www.odpm.gov.uk following the link for Building Regulations.
- > **If in any doubt, consult a qualified electrician.**
- > Switch off the mains before commencing installation and remove the appropriate circuit fuse.
- > Suitable for indoor use only.
- > This product is only suitable for use in living areas (not for areas constantly subject to moisture).
- > **WARNING: This product becomes hot!**
- > This product is not intended to be used by children and persons with sensory, physical and/or mental impairments that would prevent them from using it safely.
- > This product is suitable for installation on surfaces with normal flammability (indicated by the "F" in a triangle) e.g. wood, plasterboard, masonry. It is not suitable for use on highly flammable surfaces (e.g. polystyrene, textiles).
- > Before making fixing hole(s), check that there are no obstructions hidden beneath the mounting surface such as pipes or cables.
- > The chosen location of your new heater should allow for the product to be securely mounted and safely connected to the mains supply.
- > Do not cover the heater.
- > Do not attach to surfaces which are damp, freshly painted or otherwise electrically conductive (e.g. metallic surfaces).
- > If the location of your new heater requires the provision of a new electrical supply, the supply must conform with the requirements of the Building Regulations.
- > This product is designed for permanent connection to fixed wiring via a fused spur (with a 13 Amp fuse). We recommend that the supply incorporates a switch for ease of

- operation.
- > Make connections to the electrical supply in accordance with the following code:
 - Live - Brown or Red
 - Neutral - Blue or Black
 - Earth - Green and Yellow
 - > This product must be connected to Earth.
 - > If the external flexible cable of this heater is damaged it shall be exclusively replaced by repair or service agent or similar qualified person.
 - > You are advised at every stage of your installation to double-check any electrical connections you have made. After you have completed your installation there are electrical tests that should be carried out: these tests are specified in the Wiring Regulations (BS7671) referred to in the Building Regulations. If in doubt, consult a qualified electrician.

Installation:

- 1) Select the location of your new heater with consideration to the conditions listed above.
- 2) Remove the selected plinth and cut a rectangular hole 112mm up from the floor level and 450mm wide.
- 3) Select the required fascia colour, offer up to the heater, mark the fixing holes and secure to the plinth with the colour match screws.
- 4) Make the supply connections according to the colour code above.
- 5) Position the plinth (the heater should be resting squarely on all four feet to prevent vibration) and secure plinth using suitable fixings.
- 6) Restore the power supply.
- 7) Operate the large switch, the fan will run and blow cold air.
- 8) Operating the left hand small switch only will produce 800 Watts of heat. The right hand switch only will deliver 1600 Watts of heat.
- 9) With both switches operated the maximum heat setting of 2400 Watts will be attained.
- 10) The thermostat control may be rotated to set the temperature to the desired level. The heater and fan will switch off once the desired temperature is reached and switch on when the ambient temperature drops.

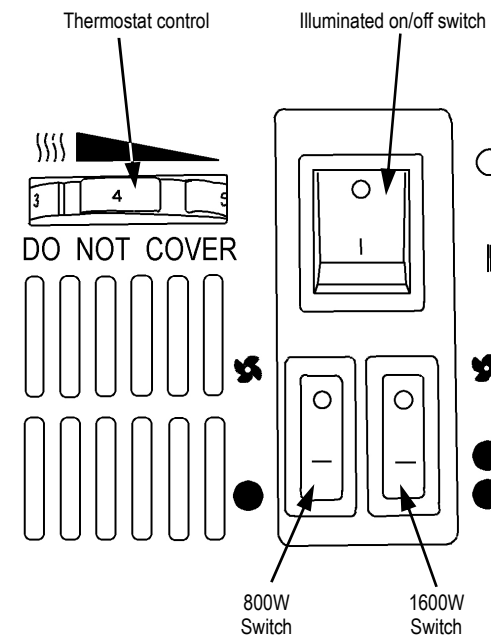
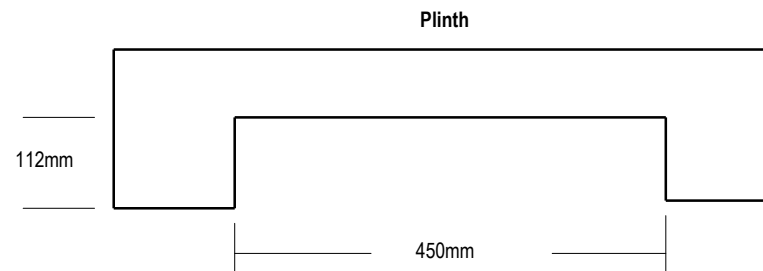
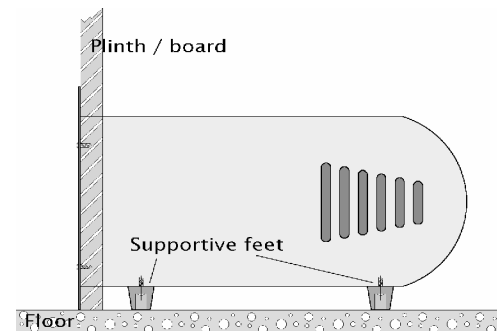

Safety markings:

